

不绝缘焊接电镀旗型端子 Non-Insulated Flag Terminal

端子材质：紫铜
电镀：镀锡

Terminal Body: Copper
Plating: Tin

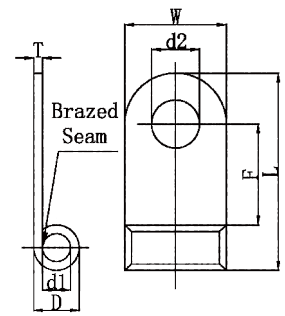

WIRE RANGE A.W.G.mm ² 压线范围	ITEM NO. 型号	STUD SIZE 螺丝孔		DIMENSION(尺寸)/mm						Q'TY BOX 最小 包装
		d2		W	F	L	D	d1	T	
22-16A.W.G 0.5-1.5mm ²	FGNB1.25-5	#10	5.3	9.6	8	16.3	3.4	1.7	0.75	1000
	FGNB2-3	#4	3.2							
16-14A.W.G. 1.5-2.5mm ²	FGNB2-5	#10	5.3		7.3	16.3	4.1	2.3	0.8	
	FGNB2-6	1/4	6.4							
12-10A.W.G. 4-6mm ²	FGNB5.5-4	#8	4.3		7.4	17.8	5.6	3.4	1	
	FGNB5.5-5	#10	5.3							
	FGNB5.5-6	1/4	6.4							
8 A.W.G. 8 mm ²	FGNB8-5	#10	5.3	12.7	9.1	23	7.2	4.5	1.2	500
	FGNB8-6	1/4	6.4							
	FGNBL8-6	1/4	6.4	15.5	13.1	28.3				
	FGNB8-8	5/16	8.4							
	FGNB8-10	3/8	10.5							
6 A.W.G. 14 mm ²	FGNB14-6	1/4	6.4	12.7	9.6	24.9	9	5.8	1.5	
	FGNB14-8	5/16	8.4	16	13.5	30.5				
4 A.W.G. 22mm ²	FGNB22-6	1/4	6.4	14	9.7	28.2	11.5	7.7	1.7	250
	FGNB22-8	5/16	8.4	17.5	13.8	34				

FGNB